

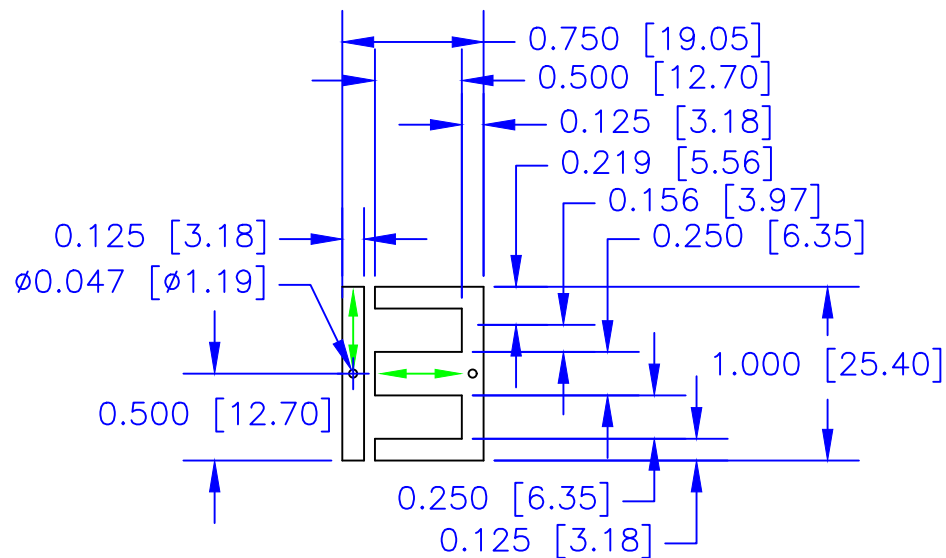

REVISIONS				
ZONE	REV	DESCRIPTION	DATE	APPROVED



←→ Line grain orientation.

General Application

1. Audio amplifiers; current, output, power.
2. Transformers: chokes and saturable reactors.
3. Ferro-resonated regulators.

Description: Has directional electrical characteristics.
Extreme high permeability and low core loss.

DIMENSIONS ARE IN INCHES [MILLIMETERS]. X.XXX = ±0.010 X.XX = ±0.03 ANGLES = ±0.05 UNLESS OTHERWISE SPECIFIED		EDCOR Electronics 7130 National Parks Highway, Carlsbad, NM 88220 Voice: (575) 887-6790 www.edcorusa.com		
DRAWING BY Brian Weston		Date 9/2012		
CHECKED BY Brian Weston		Date 9/2012		SIZE A
APPROVED BY Larry Weston		Date 9/2012		FSCM NO. DWG NO. 20000-EI025
SCALE: 1:1		©2015 EDCOR Electronics		REV SHEET: 1 of 1

EDCOR Electronics

7130 National Parks Highway, Carlsbad, NM 88220
Voice: (575) 887-6790

www.edcorusa.com

Single Phase EI-25 steel lamination
M-6, 29 Gauge - 0.014" [0.355] thick.

DRAWING BY
Brian Weston

Date
9/2012

CHECKED BY
Brian Weston

Date
9/2012

APPROVED BY
Larry Weston

Date
9/2012

SIZE
A

FSCM NO.

DWG NO.
20000-EI025

REV

SCALE: 1:1

©2015 EDCOR Electronics

SHEET: 1 of 1

