

REVISIONS				
ZONE	REV	DESCRIPTION	DATE	APPROVED

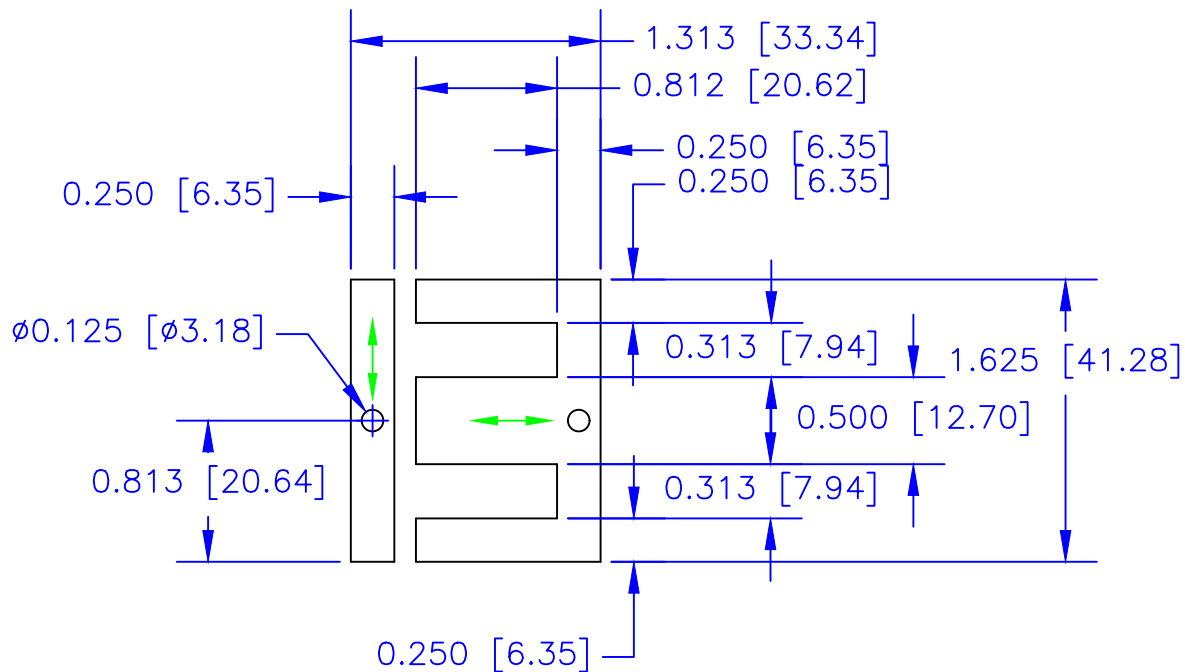

←→ Line grain orientation.

General Application

1. Audio amplifiers; current, output, power.
2. Transformers: chokes and saturable reactors.
3. Ferro-resonated regulators.

Description: Has directional electrical characteristics.
Extreme high permeability and low core loss.

DIMENSIONS ARE IN INCHES [MILLIMETERS].
X.XXX = ±0.010
X.XX = ±0.03
ANGLES = ±0.05
UNLESS OTHERWISE SPECIFIED

EDCOR Electronics

7130 National Parks Highway, Carlsbad, NM 88220
Voice: (575) 887-6790

www.edcorusa.com

Single Phase EI-50 steel lamination
M-6, 29 Gauge - 0.014" [0.355] thick.

DRAWING BY Brian Weston	Date 9/2012
CHECKED BY Brian Weston	Date 9/2012
APPROVED BY Larry Weston	Date 9/2012

SIZE A	FSCM NO.	DWG NO. 20000-EI050	REV
SCALE: 1:1	©2015 EDCOR Electronics	SHEET: 1 of 1	